

Maintenance recommendations after use (every time)

Wear full protective gear during maintenance !

Always act according to the safety instructions as supplied with each tool !

Contact the Holmatro dealer if one of the items does not work properly !

- **Necessary equipment: see check list page 12.**

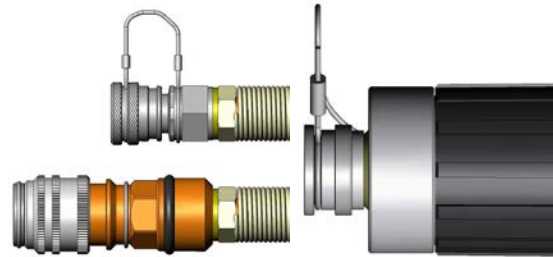

Left: SMC 4006

Right: SMC 4006 C

Step 1

- Check the cutter for completeness, oil leaks and damage. Do not use the cutter if it leaks or is damaged, and contact the Holmatro dealer.
- Check general condition of the cutter. Clean/dry the tool with soft cloth.
- Check the attachment of the carrying handle. If necessary, fasten it firmly by tightening the wing screw.

Step 2

- Check coupler(s) and dust cap(s) for damage, dirt and/or oil leakage.
- Clean coupler(s) with a clean and soft cloth, if necessary with water and soap.
- If necessary grease with hydraulic oil or use WD-40.
- Check functioning coupler(s) (see page 13).
- Reconnect loose dust cap(s) to coupler(s).

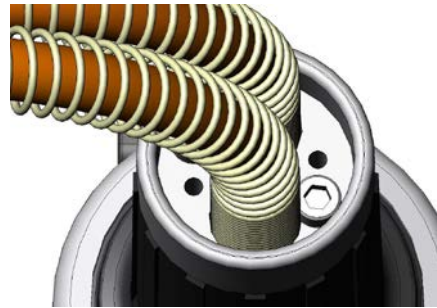

Step 3

- Check the functioning of the control handle, it must automatically return to its neutral position.
- Contact the Holmatro dealer if the handle does not work properly.

Step 4 (only for pigtail connection)

- Check the back of the control handle for oil, this will indicate that the safety valve has been activated during use (return line of the tool was not connected properly to the return line of the pump). **Pigtail connection only!**
- Clean the deadman's handle internally by blowing compressed air in the back of the handle.
- Check the hose for damage.

Manufacturing sales & service worldwide

Holmatro Rescue Equipment B.V.
 P.O. Box 33, 4940 AA Raamsdonksveer
 The Netherlands
 T + 31 (0)162 - 58 92 00
 F + 31 (0)162 - 52 24 82
 E info@holmatro.com
 www.holmatro.com

Manufacturing sales & service U.S.A., Canada and Latin America

Holmatro, Inc.
 505 McCormick Drive, Glen Burnie, MD
 21061 U.S.A.
 T + 1 - 410 - 768 - 9662
 F + 1 - 410 - 768 - 4878
 E info@holmatro-usa.com
 www.holmatro-usa.com

© Holmatro

09/08

While the greatest care has been devoted to the content, it is possible that the information in this printed matter is incorrect or incomplete. Holmatro N.V. and its affiliated companies (hereafter: Holmatro) cannot be held liable in any way for the consequences of activities undertaken on the basis of this printed matter. If you have any doubts about the correctness or completeness of the information, you shall contact Holmatro (phone number: +31 (0)162-589200).

Nothing from this printed matter can be copied and/or made public in any way without the explicit authorisation of Holmatro.

Maintenance recommendations after use, continued

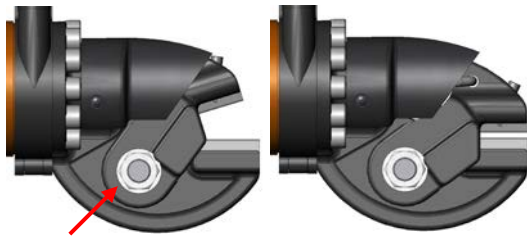
**Step 5**

- Check the presence of the lock-nut.
- Check if the upper moving part can move freely. If not see page 8 step 9 to adjust.

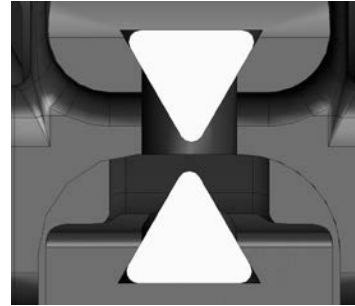
**Step 6**

- Clean the blades after use.
- Check the blades for damage, remove upsettings on the blades. Use a file and abrasive paper.
- Blades can be turned one time 120°.
- Replace, or turn blades 120° when blades are damaged.
- See page 7 “replacing the blades” to replace the blades.
- Lubricate the blades after use with preservative oil WD-40.

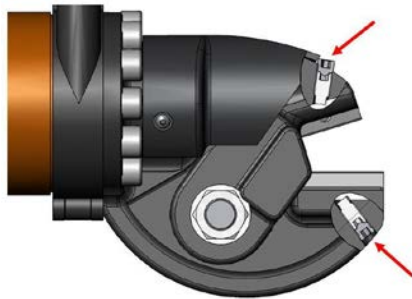
**Step 7**

- Check the presence of both locking screws.
- Both lock bolts should be tightened firmly.

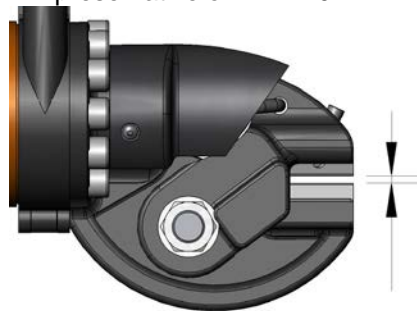
**Step 8**

- The best cutting results are obtained if the blades (jaw opening) are open 0.5 mm to 1 mm at the end of the cutting movement.
- See page 9 “Adjusting the plunger stroke” to adjust the plunger stroke.

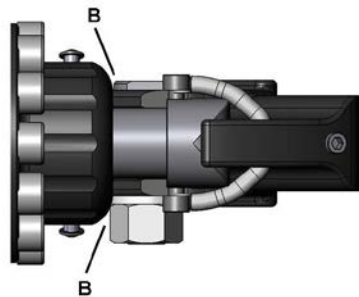
**Step 9**

- Spray Teflon lubricating oil on and between the moving parts of the centre bolt B while the tool is opening and closing (cover not shown).

**Step 10**

- Clean/dry the tool with soft cloth before storing it.
- Lightly oil steel parts with preservative oil WD-40.
- Store the cutter in a dry and well-ventilated area.
- Do not fully close the cutter, always keep a few mm for opening, so that the tool can be stored without pressure.

Monthly maintenance recommendations (or after 10 hours of use)

Wear full protective gear during maintenance !

Always act according to the safety instructions as supplied with each tool !

Contact the Holmatro dealer if one of the items does not work properly !

- **Necessary equipment: see check list page 12.**

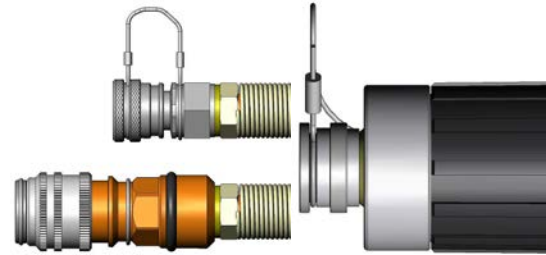

Left: SMC 4006

Right: SMC 4006 C

Step 1

- Check the operation of the tool by opening and closing the cutter 2 times.
- No cracking sounds can be heard.
- Check the tool for damage and leaking. If the tool doesn't work properly and/or leaks, contact the Holmatro dealer.

Step 2

- Check coupler(s) and dust cap(s) for damage, dirt and/or oil leakage.
- Clean coupler(s) with a clean and soft cloth, if necessary with water and soap.
- If necessary grease with hydraulic oil or use WD-40.
- Check functioning coupler(s) (see page 13).
- Reconnect loose dust cap(s) to coupler(s).

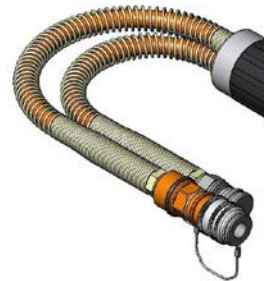

Step 3

- Check whether the deadman's handle returns to its neutral position.
- Check the operation of the deadman's handle. Have the Holmatro dealer repair the deadman's handle if it doesn't function properly.

Step 4 (only for tools with pigtail hoses)

- Check pigtail hose(s) and mounting of the couplers.
- Replace the pigtail hose when:
 - damages are visible
 - the steel inner layer is visible
 - blisters are visible
 - obvious traces of kinks are visible
 - cuts are visible
 - protection spring is not mounted well



Step 5

- Check the presence of the upper m. Check if the upper m freely.
- If not, see page 8 step 9.



Step 6

- Check the carrying handle for damage. Replace a damaged carrying handle.
- Check the attachment of the carrying handle. If necessary, fasten it firmly by tightening the wing screw.